

NORWALK

Transportation Master Plan

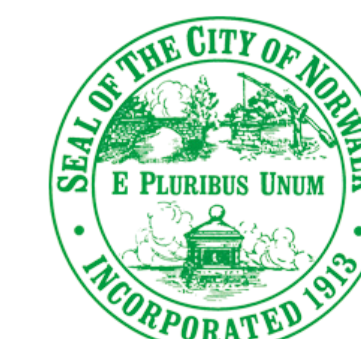

Welcome!

Transportation affects all of us, regardless of where, how, and how often we travel. We take trips to work, to school, to shop, to see the doctor, and to connect with our family and friends.

How will we continue to improve the travel experience in Norwalk?

Plan Purpose

The Transportation Master Plan will guide transportation policy and investment over the next 10 to 20 years. Having a well-planned and coordinated transportation network is vital to the economic health of Norwalk.

This master plan will help City of Norwalk deliver transportation improvements that align with best practices, forward-thinking design, and community-driven need. The plan will provide guidance on funding opportunities, project development, and equitable allocation of resources.

Advancing the Work

Above all, the purpose of the Transportation Master Plan is to help Norwalk advance improvement projects by consolidating public support, leveraging the latest data to confirm needs, and positioning the City for funding opportunities.

The TMP is designed as a living document, allowing for updates and evolution, as well as a public-facing record of City progress.

A Vision for Norwalk

Norwalk's Plan of Conservation and Development (Citywide Plan) defines a vision for mobility in Norwalk:

We're a city of transportation choice: a connected, walking and biking city, well-served by public transportation, safe and convenient pedestrian and bicycle routes to city destinations, well-maintained and well-functioning local streets, and efficient regional transportation links.

Transportation Master Plan Framework

Norwalk is a rapidly growing and evolving city. Prior city planning conducted by Transportation, Mobility and Parking; Redevelopment Agency; Health Department; and Planning Commission point to city objectives that must be addressed both now and into the future.

Norwalk objectives with transportation linkages:

- Support future population growth and diversity
- Support commuter flows into, out of, and within Norwalk
- Attract and retain residents and businesses
- Accommodate trip growth by expanding non-auto mode share
- Enhance the quality of life for all, socially and economically
- Mitigate obesity-related illness
- Protect the environment and mitigate climate-related impacts
- Eliminate human-caused injury and death

Transportation Master Plan Goals and Process

Transportation Mission:
Provide safe, comfortable and efficient mobility and accessibility opportunities to residents, businesses, and visitors

Goals:
Equity
Resiliency
Safety
Choice
Environment
Technology

Needs:
Community-sourced and data-informed issues that relate to one or more Goals and direct the TM&P Department to coordinate the initiation of projects

Strategies:
Toolbox of potential solutions, both policy and physical, that can address needs and link to funding sources for future action



Six Aspirational Goals

The City of Norwalk has developed a draft TMP to improve transportation and guide investment for the next 10-20 years. The plan is based on six ambitious goals. To address these goals, the Transportation Master Plan looks at how we travel today, considers the opportunities and challenges associated with travel in Norwalk, and provides strategies and an action plan to enact positive change.

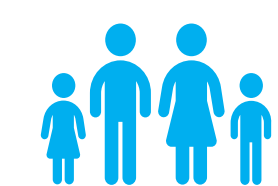

Place dots on up to 2 goals to indicate which goals resonate with you.

 **Equity & Environmental Justice**
Norwalk seeks to eliminate existing and historical barriers to transportation access.

 **Resiliency**
Norwalk will have a sustainable transportation network that prevents failures and mitigates unforeseen events.

 **Safety**
Norwalk expects to eliminate fatalities and serious injuries on all modes by prioritizing people, safety, and livability over motor vehicle throughput and speed.

 **Environment**
Norwalk will invest in and prioritize the design and construction of a carbon-neutral transportation system.

 **Technology**
Norwalk will lead Connecticut in the development and implementation of technology to advance the travel experience for all residents and visitors in the city.

 **Transportation Choice**
Norwalk will be a “15-minute city”, accessible completely by walking, bicycling, and/or transit.



Community Voices

Ideas, concerns, and opportunities presented by community members, stakeholders, and the TMP Technical Advisory Committee are the primary inputs steering this assessment of mobility needs. The TMP begins with real-life input and cross-references comments with available data to validate and refine the areas of interest.

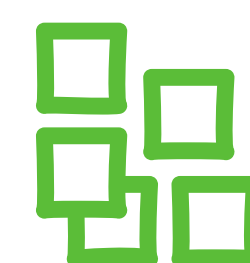

39 Post-its and Additional NICE Festival Conversations



Nearly 1,000 Survey Responses



850+ Interactive Map Pins



Conversations with Community Leaders

Desires

- Create better connections between Norwalk’s neighborhoods and downtowns
- Connect different travel modes better (e.g., train to sidewalk, bike to bus, parking to sidewalk)
- Improve sidewalk condition and close gaps in the sidewalk network
- Improve efficiency and convenience of the local bus network
- Complete the Norwalk River Valley Trail and other off-road connections for non-motorized travel (local and regional)

Perceived Barriers to Travel in Norwalk

n=998, tally includes multiple responses per participant

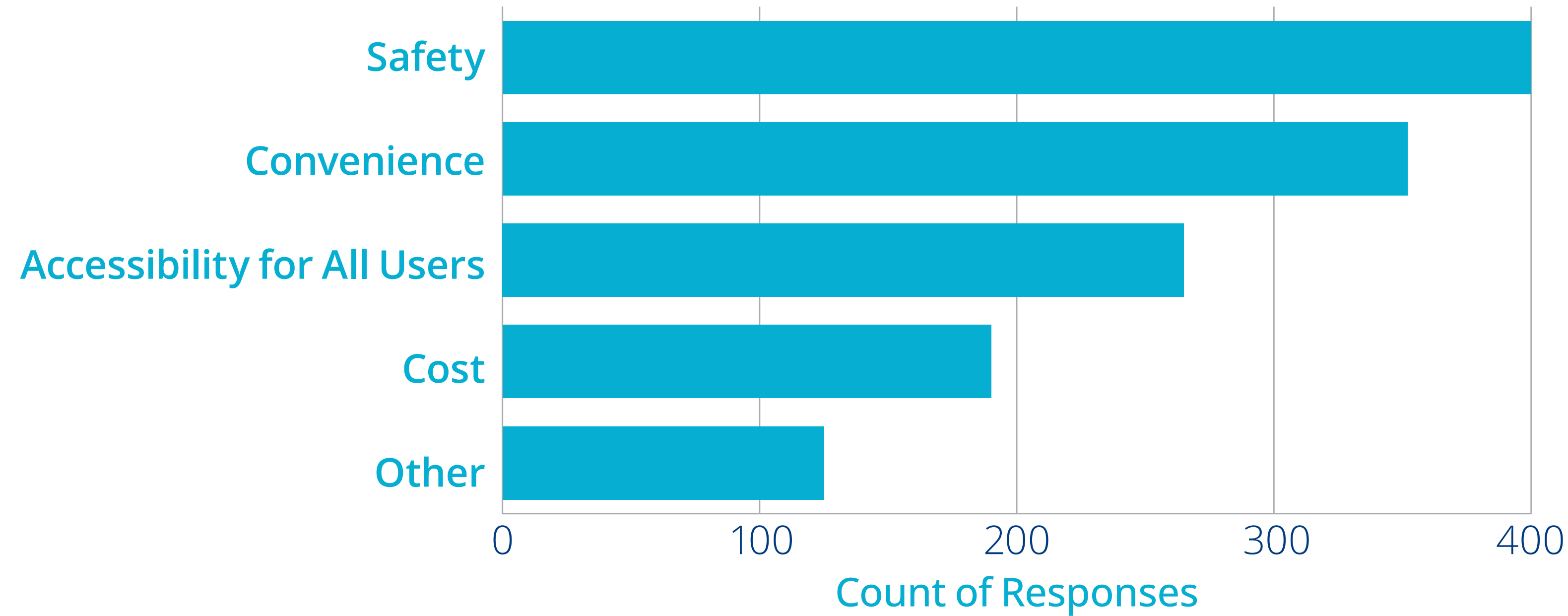

Feedback from TMP Online Survey, September 2021 - October 2022

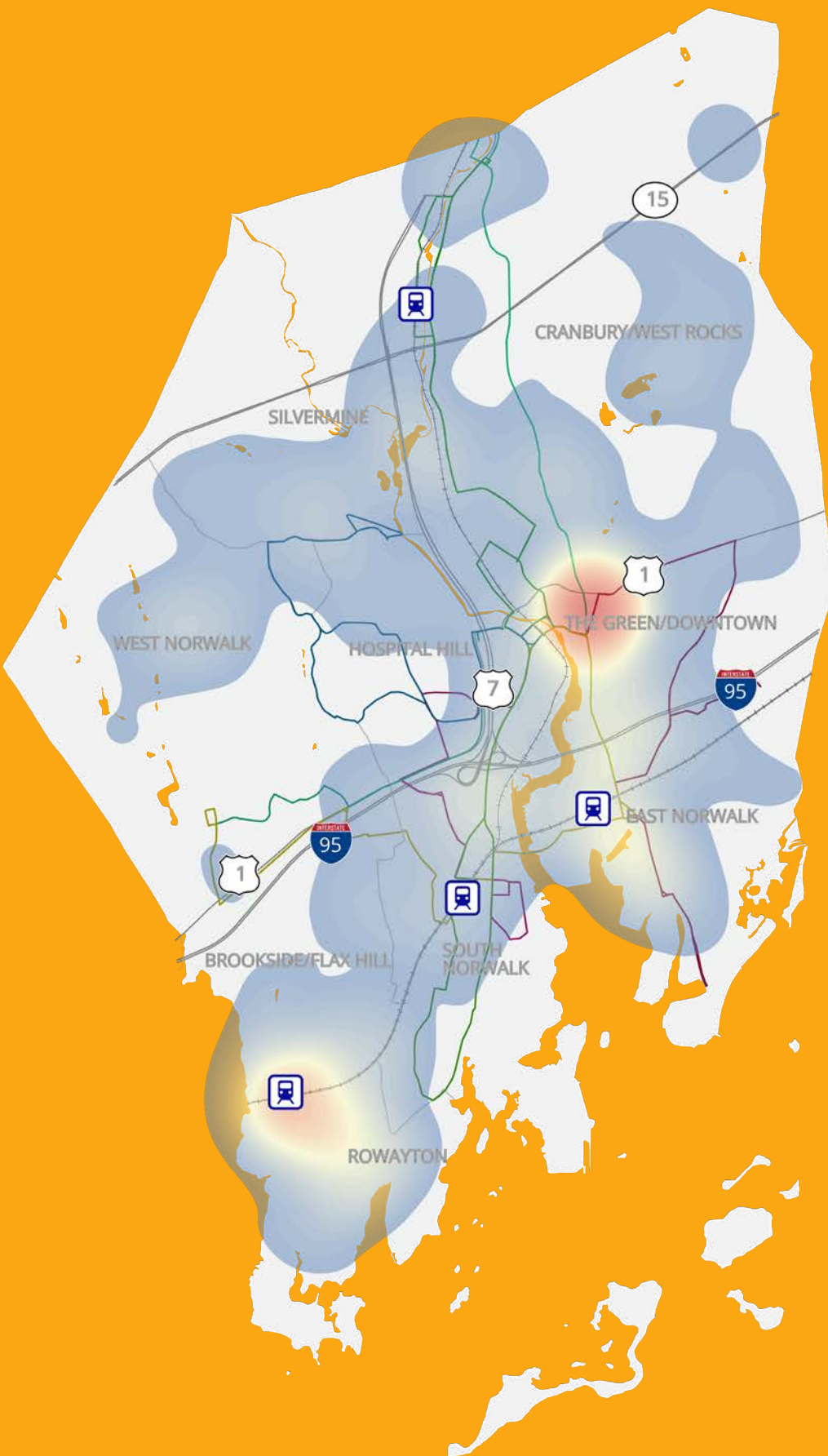

Concerns

- Safety improvements are needed for pedestrians and bicyclists
- Parking availability can be challenging in both commercial and residential areas
- Parking demand at regional attractions (e.g., Calf Pasture Beach) and major events spills into local residential streets
- Truck traffic is impacting local neighborhoods
- Police enforcement alone does not deter aggressive driving

Map: Safety Concerns
Mapped feedback from TMP online mapping survey, September 2021 – October 2022

Opportunities

- Use technology to improve traffic signals, transit services, parking information, and other aspects of the local transportation network
- Design transportation facilities for the community Norwalk wants to be
- Adjust services and designs as needs evolve
- Increase residential development in the urban core and promote multimodal mobility options through walking, bicycling, and transit

Photo: NICE Festival



Transportation Needs

Transportation needs have been identified through community feedback and analysis of several data sources focused on mobility, accessibility, and safety. The map to the right displays the general categories of need distributed city-wide. The Transportation Master Plan includes needs to help the city plan for and initiate projects, but is also flexible to allow for additional needs to be identified on an ongoing basis.



Bicycle/Pedestrian Access and Safety

Transit Access and Modernization

Truck Access and Safety

Traffic Mitigation and Road Safety

Village Districts, Parking, Wayfinding and Placemaking

Early Actions

Concept Plans

- 1 Main Street
- 2 North Main Street / MLK Boulevard / West Avenue
- 3 Calf Pasture Beach Road

Sidewalk Plans

- 4 George Avenue (Tierney Street to Route 1)
- 5 Linden Street (Main Avenue to West Rocks Road)
- 6 Riverside Avenue (Route 1 to New Canaan Avenue)

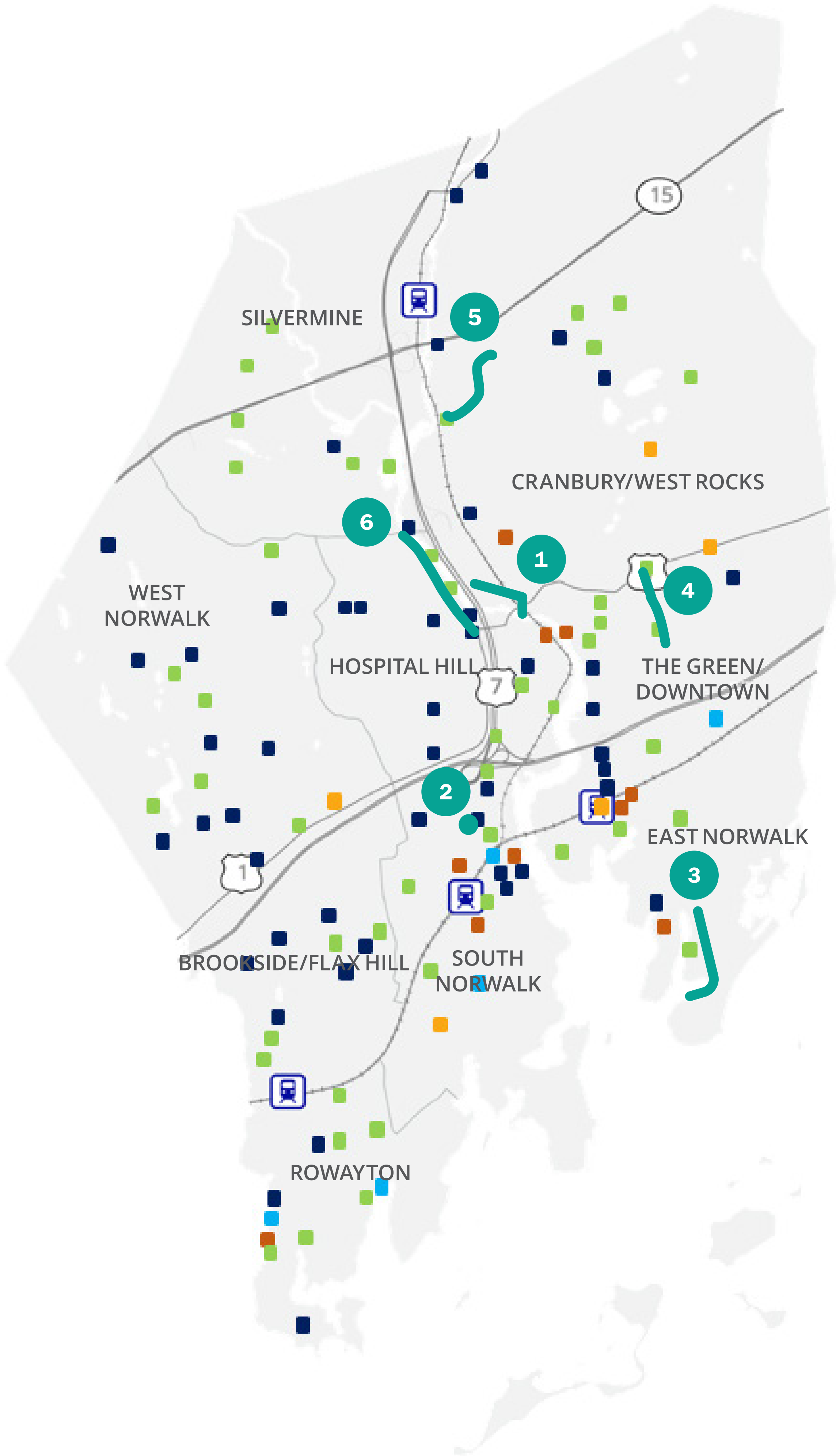

Early Actions

This Transportation Master Plan focused effort on several corridors throughout the city to advance conceptual design work representative of the strategies and actions outlined in the plan. Three assessments of potential new sidewalk installation, along with three roadway design concepts, demonstrate what is possible and work that can be advanced relatively quickly. As each of these locations moves forward, further engagement is warranted.

1 Main Street (Potential Funding Opportunity)

- Enhance walking environment and safety
- Explore intersection redesign
- Revitalize streetscape

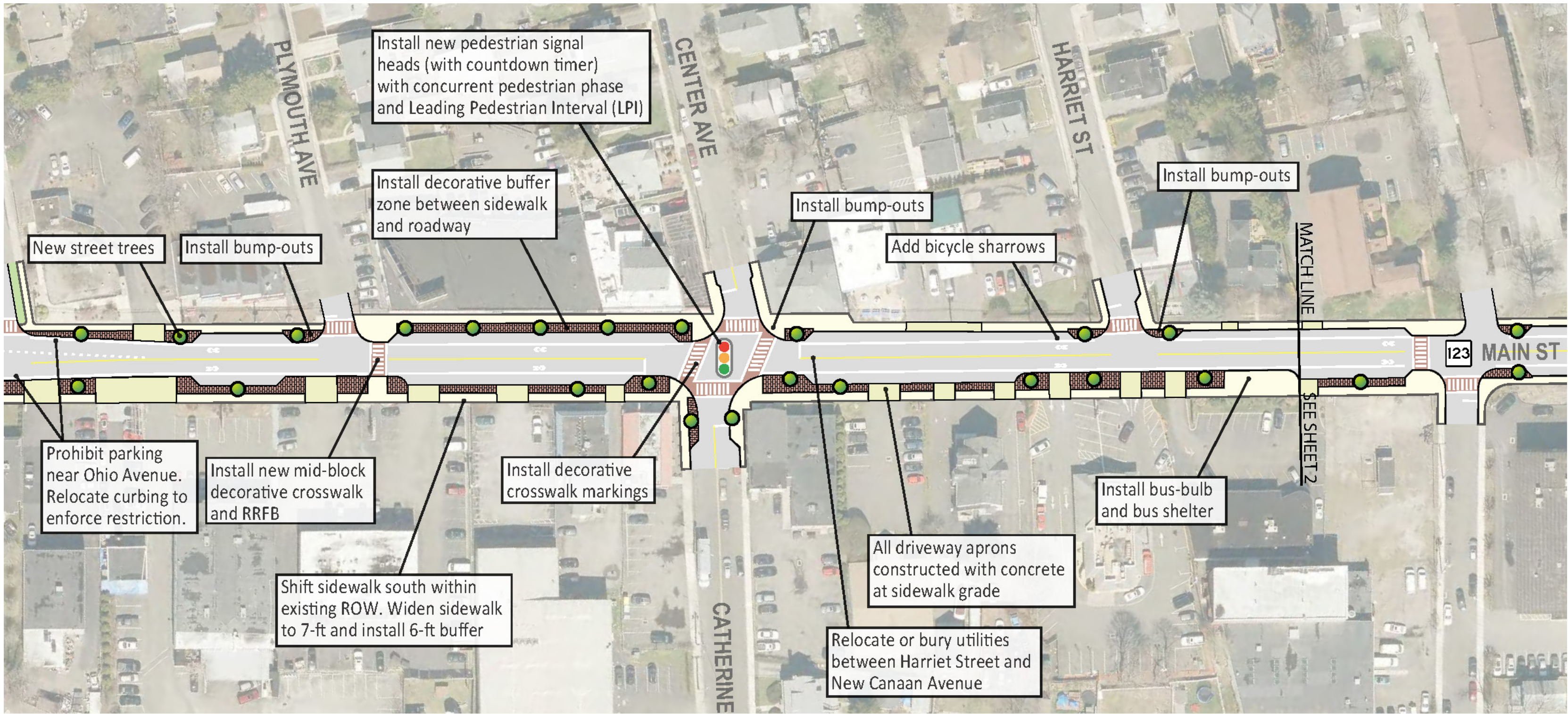

Draft Concept for Main Street from New Canaan Avenue to Hoyt Street – Sample Section

Sidewalk Plans at Three Locations:

- 4 George Avenue (Tierney Street to Route 1)
- 5 Linden Street (Main Avenue to West Rocks Road)
- 6 Riverside Avenue (Route 1 to New Canaan Avenue)



2 North Main Street, MLK Boulevard, West Avenue (Potential Early Action)

- Test traffic volumes and movements
- Design turn lane pocket, lane configurations
- Design signal phases

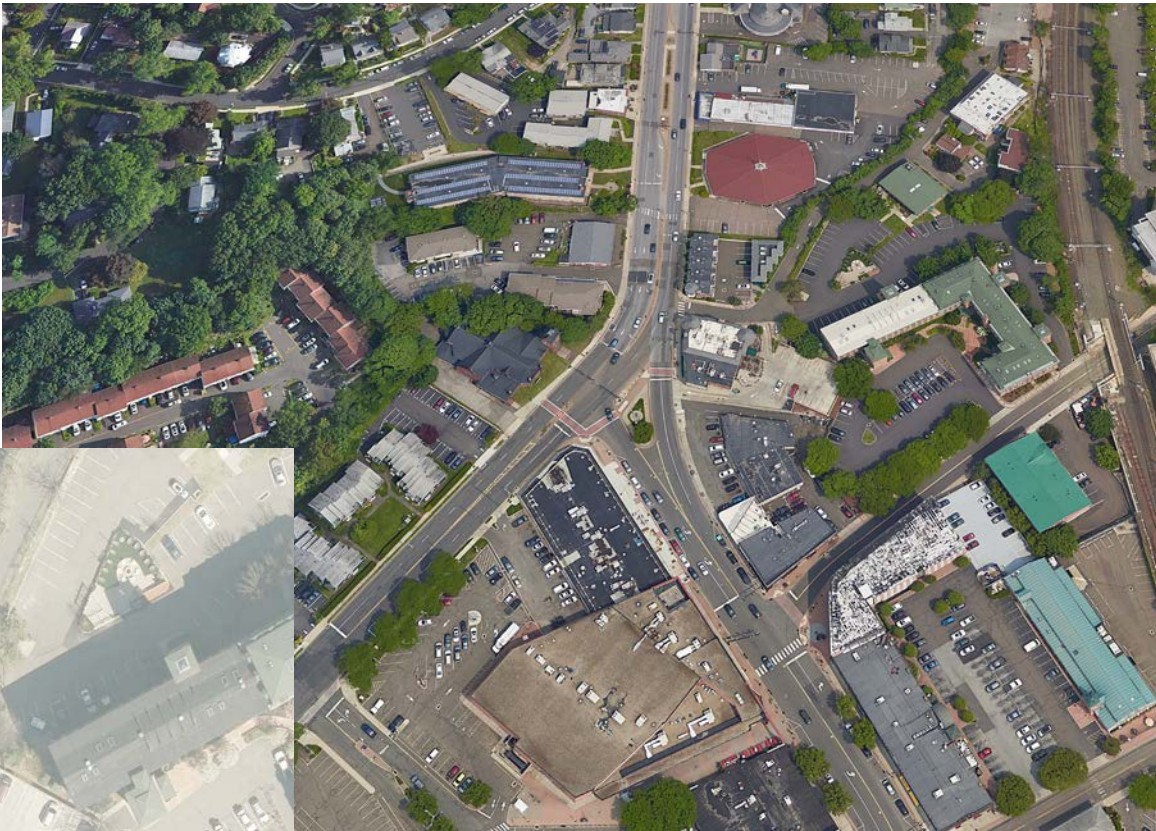

Draft Concept for North Main Street at MLK Boulevard and West Avenue

3 Calf Pasture Beach Road (Future Concept)

- Encourage and facilitate safe, active transportation options
- Mitigate overflow beach parking in neighborhood
- Manage beach and event traffic
- Integrate street trees and green stormwater collection system

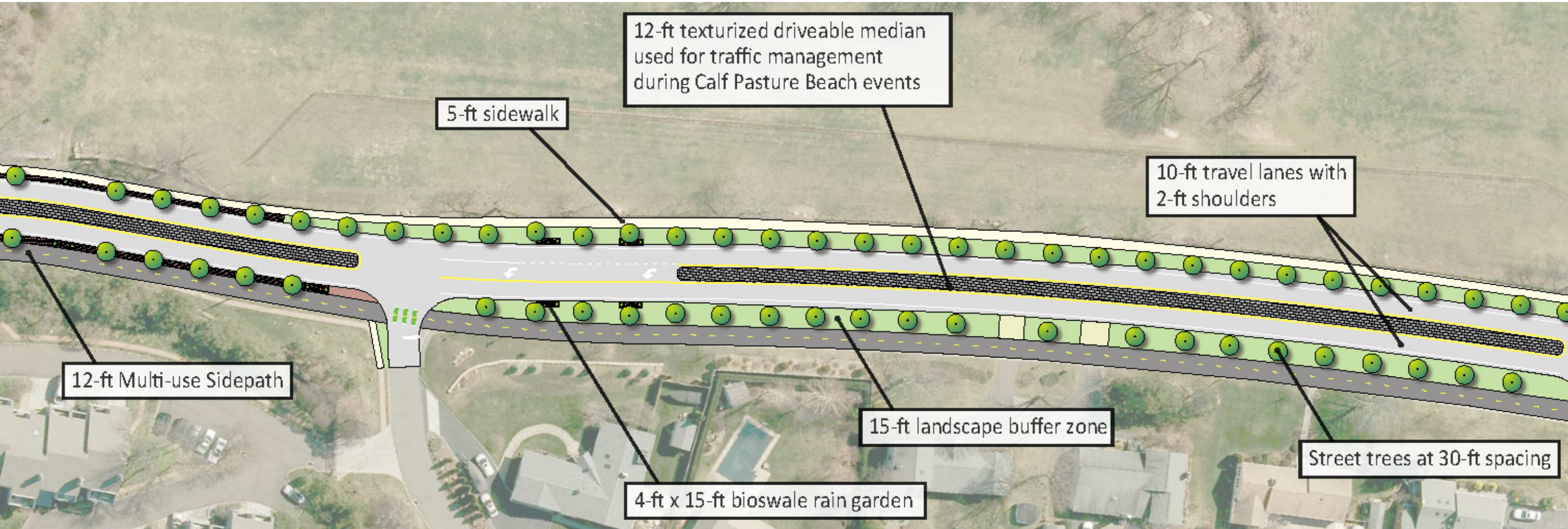

Draft Concept for Calf Pasture Beach Road from Marvin Street to Comber Drive – Sample Section

